

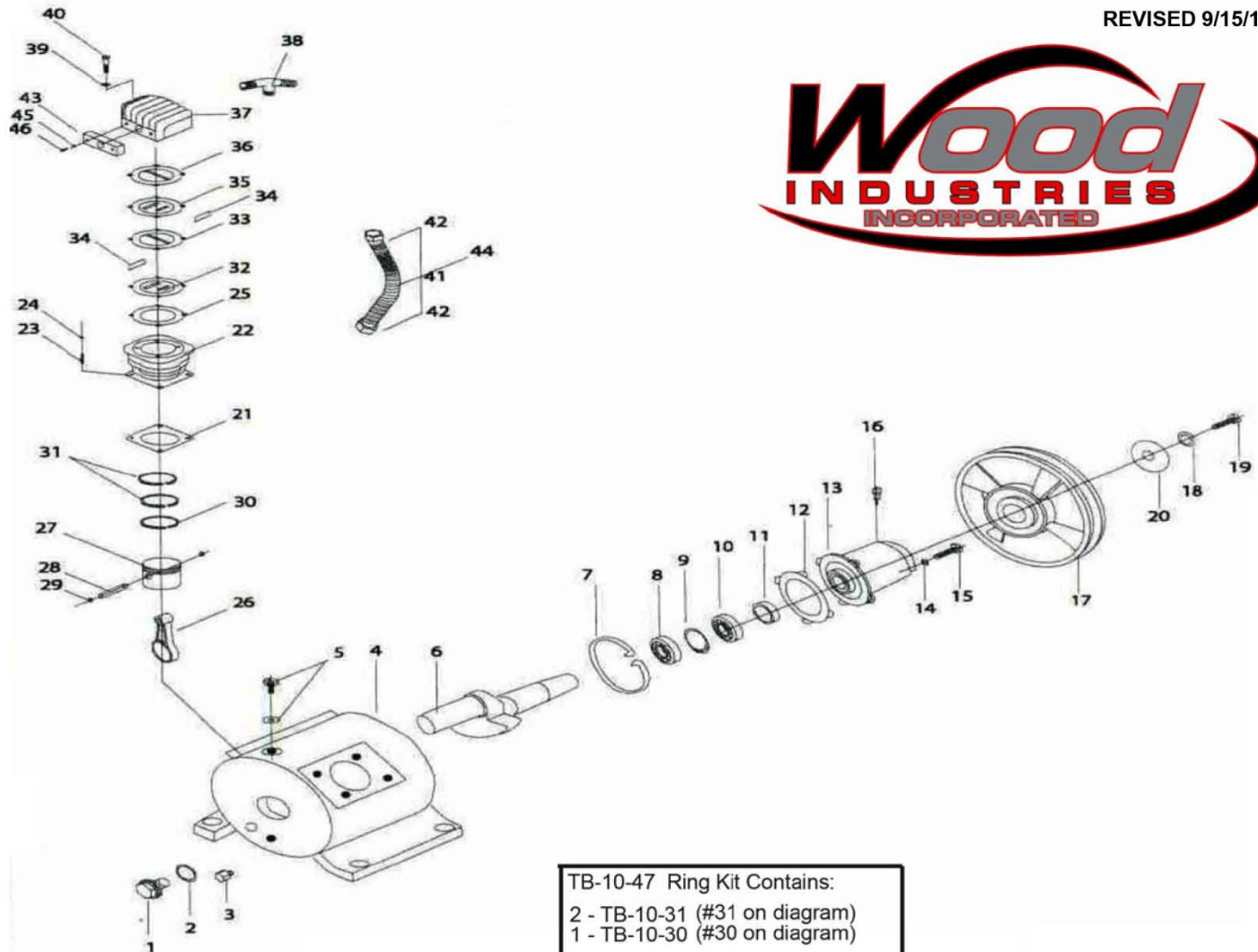

| Item | Description                    | Qty | Part #    |
|------|--------------------------------|-----|-----------|
| 1    | Oil sight gauge                | 1   | TB-10-01  |
| 2    | Oil sight gauge gasket         | 1   | TB-10-02  |
| 3    | Oil drain plug                 | 1   | TB-10-03  |
| 4    | Crankcase                      | 1   | TB-10-04  |
| 5    | Oil fill plug & "O" ring       | 1   | TB-10-05  |
| 6    | Crankshaft                     | 1   | TB-10-06  |
| 7    | Front bearing snap ring        | 1   | TB-10-07  |
| 8    | Front bearing                  | 1   | TB-10-08  |
| 9    | Rear bearing snap ring         | 1   | TB-10-09  |
| 10   | Rear bearing                   | 1   | TB-10-10  |
| 11   | Oil seal                       | 1   | TB-10-11  |
| 12   | Crank - rear bearing housing   | 1   | TB-10-12  |
| 13   | Rear bearing housing           | 1   | TB-10-13  |
| 14   | Rear bearing housing washer    | 4   | TB-10-14  |
| 15   | Rear bearing housing bolt      | 4   | TB-10-15  |
| 16   | Crank breather & "O" ring      | 1   | TB-10-16  |
| 17   | Flywheel                       | 1   | TB-10-17  |
| 18   | Flywheel lockwasher            | 1   | TB-10-18  |
| 19   | Flywheel bolt                  | 1   | TB-10-19  |
| 20   | Flywheel washer                | 1   | TB-10-20  |
| 21   | Cylinder - crankcase gasket    | 2   | TB-10-21  |
| 22   | Cylinder                       | 2   | TB-10-22  |
| 23   | Cylinder mounting screw        | 8   | TB-10-23  |
| 24   | Cylinder mounting nut          | 8   | TB-10-24  |
| 25   | Valve seat - cylinder gasket   | 2   | TB-10-25  |
| 26   | Connecting rod                 | 2   | TB-10-26  |
| 27   | Piston                         | 2   | TB-10-27  |
| 28   | Piston pin                     | 2   | TB-10-28  |
| 29   | Piston pin clip                | 4   | TB-10-29  |
| 30   | Oil control ring               | 2   | TB-10-30  |
| 31   | Compression ring               | 4   | TB-10-31  |
| 32   | Lower valve seat               | 2   | TB-10-32  |
| 33   | Middle alum. valve seat gasket | 2   | TB-10-33  |
| 34   | Valve plate reed               | 4   | TB-10-34  |
| 35   | Upper valve seat               | 2   | TB-10-32  |
| 36   | Cylinder head gasket           | 2   | TB-10-36  |
| 37   | Cylinder head                  | 2   | TB-10-37  |
| 38   | 3-way interstage connector     | 1   | TB-10-38  |
| 39   | Cylinder head bolt washer      | 8   | TB-10-39  |
| 40   | Cylinder head bolt             | 8   | TB-10-40  |
| 41   | Interstage tube with fins      | 1   | TB-10-41  |
| 42   | Interstage tube connector nut  | 2   | TB-10-42  |
| 43   | Air filter assembly            | 2   | TB-30-04  |
| 44   | Interstage tube assembly       | 1   | TB-10-44  |
| 45   | Air filter assembly washer     | 4   | TB-10-45  |
| 46   | Air filter assembly bolt       | 4   | TB-10-46  |
| 47   | Ring Kit                       | 1   | TB-10-47  |
| 48   | Valve Repair Kit               | 1   | TB-10-48  |
| 49   | Filter Element (not shown)     | 1   | TB-10-43E |



- |   |
|---|
| <p>TB-10-47 Ring Kit Contains:</p> <ul style="list-style-type: none"> <li>2 - TB-10-31 (#31 on diagram)</li> <li>1 - TB-10-30 (#30 on diagram)</li> </ul> <p>TB-10-48 Valve Repair Kit Contains:</p> <ul style="list-style-type: none"> <li>1 - TB-10-05 (#5 on diagram)</li> <li>1 - TB-10-36 (#36 on diagram)</li> <li>1 - TB-10-33 (#33 on diagram)</li> <li>2 - TB-10-32 (#32 on diagram)</li> <li>2 - TB-10-34 (#34 on diagram)</li> </ul> |
|---|

1-800-551-2406

