

**LIBERTY
BUILDING
PRODUCTS**

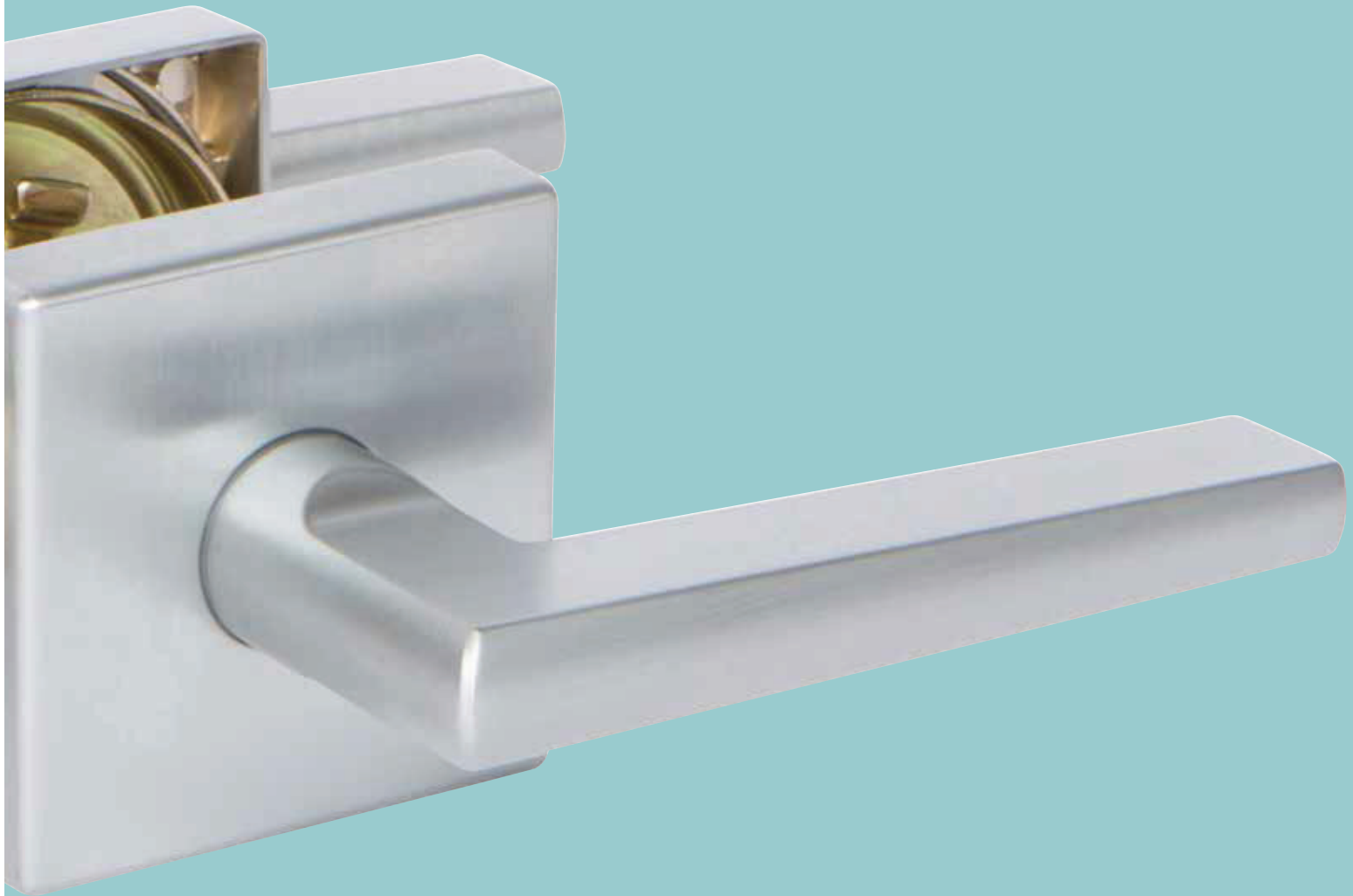

EZSET[®]
R E S I D E N T I A L

Security Features

200B Series ANSI Grade 3 Certified Deadbolt

(ANSI/BHMA A156.36-2010) for Auxiliary Locks

Product meets and exceeds ANSI Grade 3 requirements for auxiliary locks

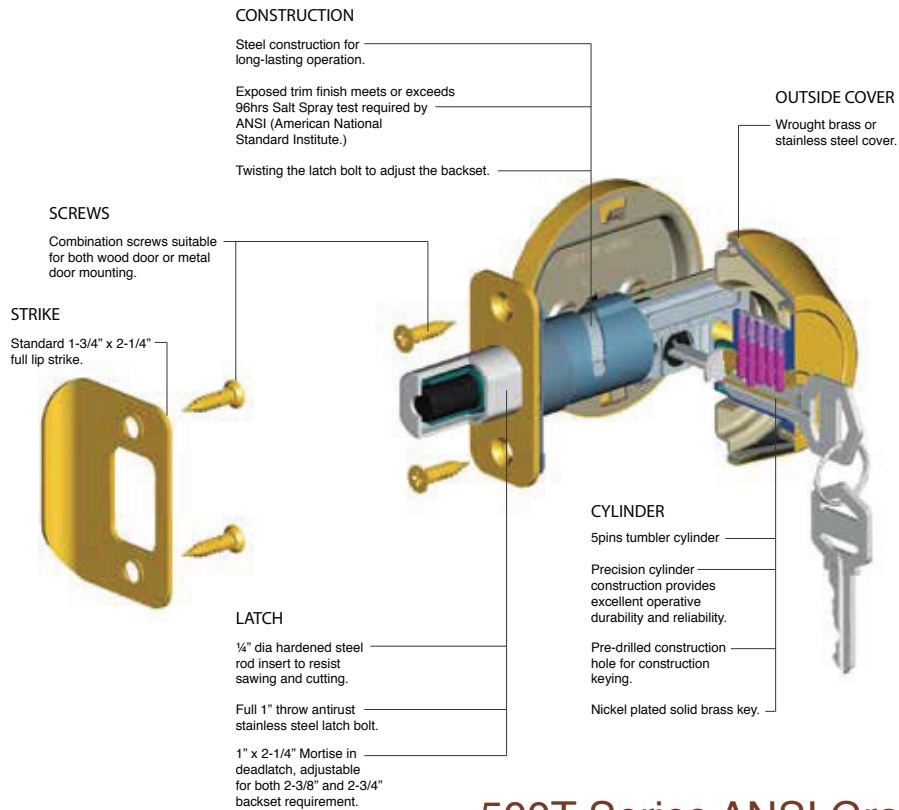

500T Series ANSI Grade 3 Certified Leverset

(ANSI/BHMA A156.2-2011) for bored & preassembled locks & latches

Product meets and exceeds ANSI Grade 3 requirements for single-point locks and latches

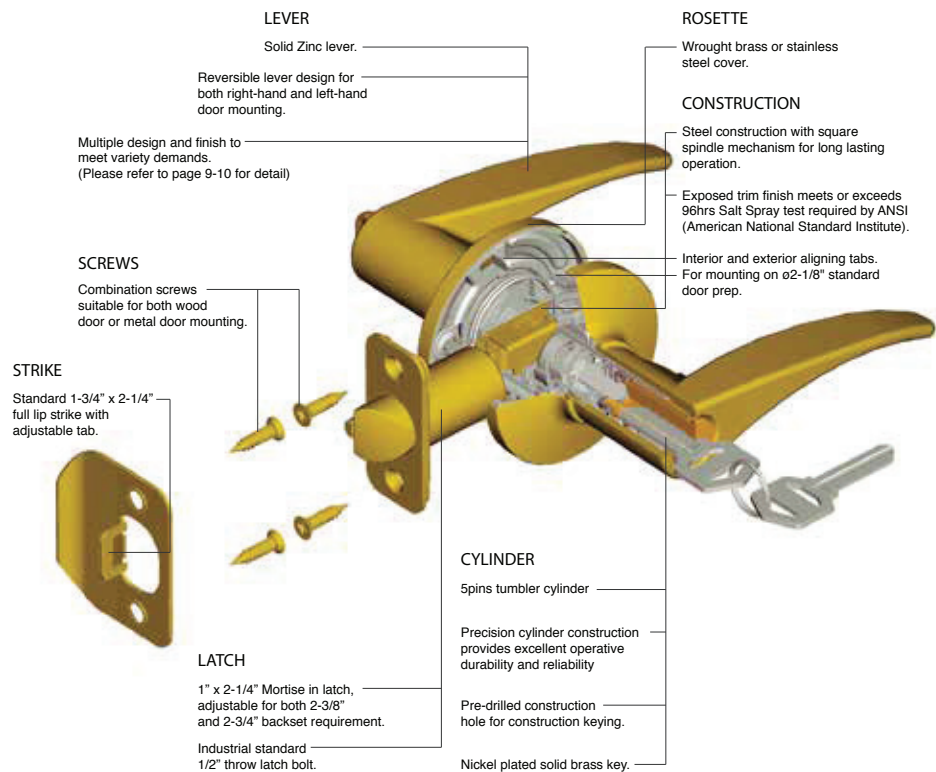

Functions

400 Series Handleset – ANSI A156.2, Series 4000, Grade 3

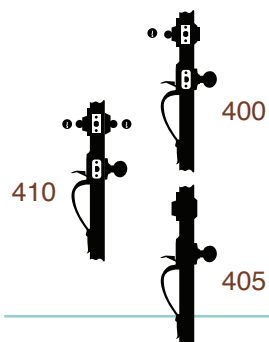

400 Single Cylinder Handleset

Deadbolt thrown or retracted by key from outside or by inside turnpiece. Latch retracted by thumbpiece from outside or by inside knob/lever.

400 Single Cylinder Interconnected Handleset (ANSI F102)

Deadbolt thrown or retracted by key from outside or by inside turnpiece. Latch retracted by thumbpiece from outside or by inside knob/lever. Both deadbolt and latch bolt are retracted to unlocked position by operating inside lever.

410 Double Cylinder Handleset

Deadbolt thrown or retracted by key from either side. Latch retracted by thumbpiece from outside or by inside knob/lever.

405 Dummy Handleset

For use as door pull or as dummy trim on inactive leaf of double door. Fixed thumbpiece and inside knob/lever. Dummy cylinder with inside plate.

500T Series Lever Lock – ANSI A156.2, Series 4000, Grade 3

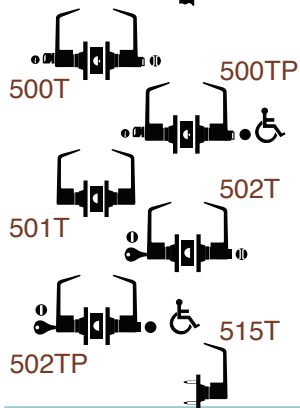

500T Entrance

Turn button lock/unlock outside lever. Key lock/unlock from outside.

500TP Entrance (Push Button)

Push inside button locks outside lever. Key lock/unlock from outside. Unlock by push down inside lever.

501T Passage

Both levers always unlocked.

502T Privacy

Turn inside button locks outside lever. Can be opened from outside using outside turn mechanism.

502TP Privacy (Push Button)

Turn inside button locks outside lever. Can be opened from outside using outside turn mechanism. Unlock by push down inside lever.

515T Dummy

Dummy trim for one side on door. Used for door pull or matching inactive trim.

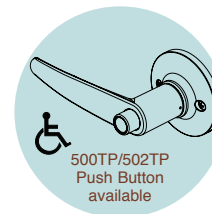

100T Series Knob Lock – ANSI A156.2, Series 4000, Grade 3

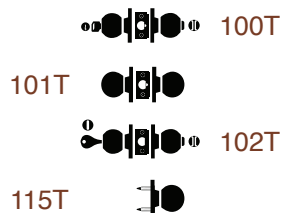

100T Entrance

Turn button lock/unlock outside knob. Key lock/unlock from outside.

101T Passage

Both knobs always unlocked.

102T Privacy

Turn inside button locks outside knob. Can be opened from outside using outside turn mechanism.

115T Dummy

Dummy trim for one side on door. Used for door pull or matching inactive trim.

200 Series Deadbolt Lock – ANSI A156.36, Grade 3

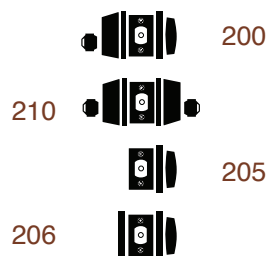

200 Single Cylinder

Deadbolt thrown or retracted by key from outside or by inside turnpiece.

210 Double Cylinder

Deadbolt thrown or retracted by key from either side.

205 One-sided Half-Bore

Deadbolt thrown or retracted by thumbpiece from inside.

206 One-sided Full-Bore

Deadbolt thrown or retracted by thumbpiece from inside. Cover plate outside.

300 Series Interconnected Locks – ANSI A156.12, Grade 3

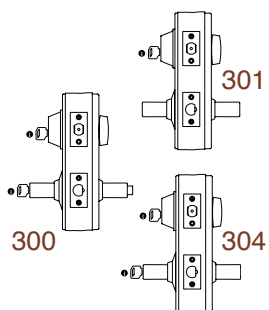

301 Entrance Single Locking, ANSI F95

Latch bolt operated by lever from either side. Deadbolt operated by turn from inside or key from outside. Operating inside lever retracted both deadbolt and latch bolt.

300 Entrance Double Locking, ANSI F97

Deadbolt operated by key from outside or by turnpiece inside. Deadlatch is locked by key from outside or by push button from inside. Turn inside lever to release deadbolt and latchbolt simultaneously for immediate exit. Latch deadlocks when door is closed.

304 Storeroom Double Locking, ANSI F98

Deadbolt operated by key from outside or by turnpiece inside. Outside lever is fixed, entrance by key only. Turn inside lever to release deadbolt and latchbolt simultaneously for immediate exit. Latch deadlocks when door is closed.



by LIBERTY BUILDING PRODUCTS

Contemporary Design

DEXTON HANDLESET

AM SERIES LEVER



HOLLYWOOD (HW)

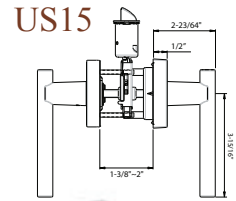

DEXTON (DT)
US26



SOHO RC (SH) US26
Round Rosette

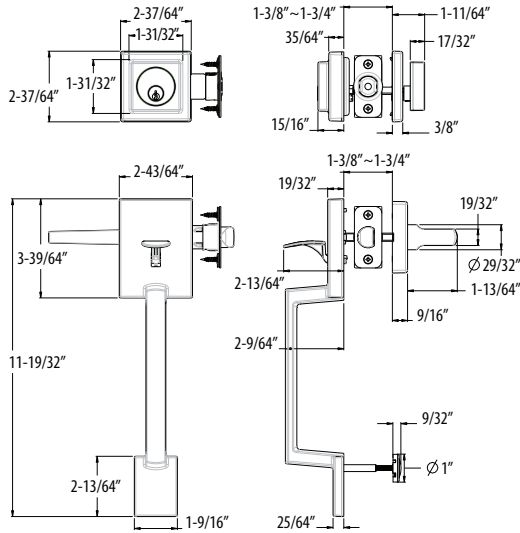
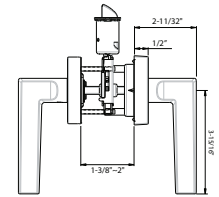

SOHO SQ (SH) US15
Square Rosette

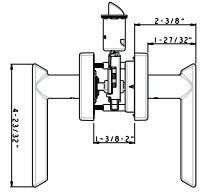

AUSTIN (AT)
US26

FINISHES



US15
Satin Nickel



US26
Polish Chrome



US26D
Satin Chrome
(SOHO & Deadbolt only)

Spring Latches for AM Series (SH/HW/AT)

Optional: G90A3T square corner

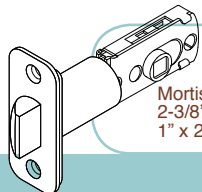

G90A3R

Mortise Spring Latch
2-3/8" or 2-3/4" adjustable backset
1" x 2-1/4" Round Corner Faceplate



G90A3C

Drive-in Spring Latch
2-3/8" or 2-3/4" adjustable backset
1" Diameter

D927

Spring latch drive-in cap for converting
mortise latch to Drive-in Latch

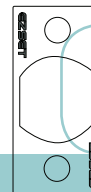

9782-square 9783-round

4-way plate is available for
converting drive-in latch to
1" x 2-1/4" square mortise latch.

ANSI Grade 3



5-1/2" CTC INTERCONNECTED LOCK IP / IQ / IS NEW!

200LT DEADBOLT

IP
US26

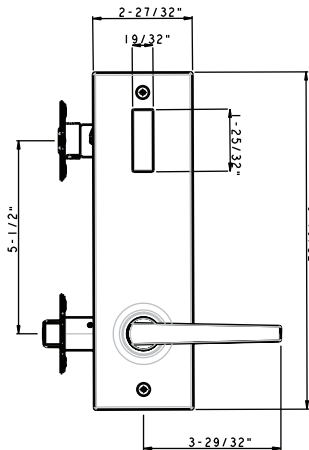

IP - AM Series lever on both side.
IQ - 500T Series lever on both side.
IS - 500T Series lever outside,
AM series lever inside.

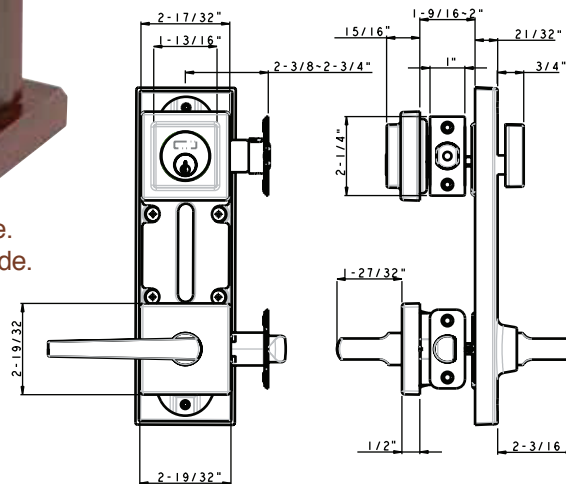

LTR
US26

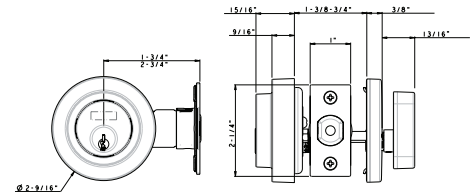

LTS
US26

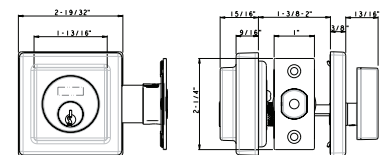

SPECIFICATIONS

Door Prep	2-1/8" cross bore, 1" edge bore.
Door Fitting	Handleset: 1-3/8"~1-3/4", 2" door with thick door kit. Deadbolt/Lever 1-3/8"~2".
Cylinder	KW1 standard, SC1 optional.
Latch	2-3/8" and 2-3/4" adjustable. UL latch for IS/IP series.
Latch Bolt	Deadbolt: 1" throw. Lever: 1/2" throw.
Strike	2-1/4" full lip round corner.
Door Handing	Handleset/Privacy Lever: handed (specify LH or RH when ordering).
ADA	Deadbolt Interior turn piece & Privacy Lever with Push Button. Meets 4.13.9 ADA requirements.



by LIBERTY BUILDING PRODUCTS

Interconnected

ENTRANCE HANDLESETS



CHATEAU (CH)
US10B

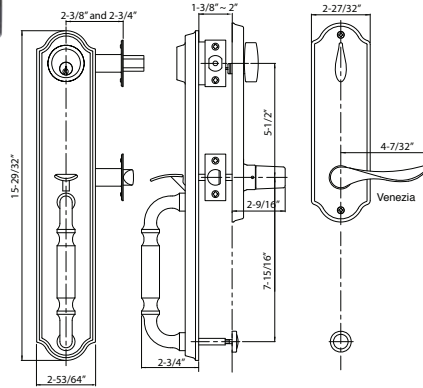

FAIRMONT (FT)
US15

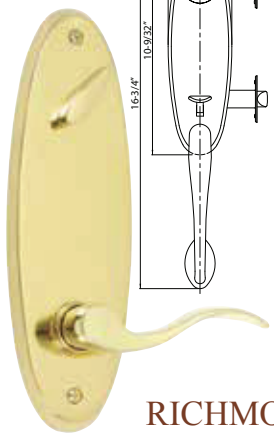
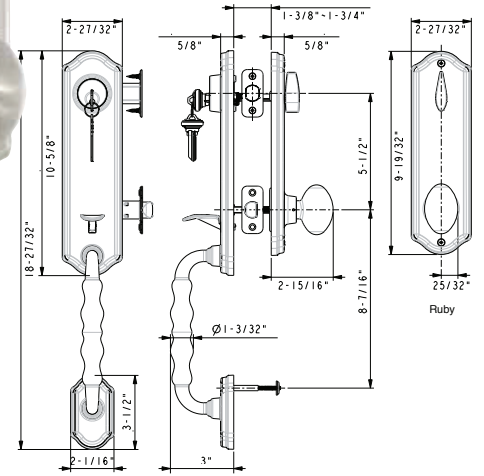

RICHMOND (RI)
PVD

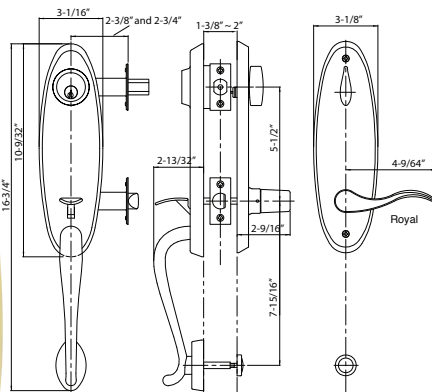

4" CTC IL SERIES

ANSI Grade 2



300IL-SD-US15
San Diego (SD) Lever



301IL-CT-US15
Charlotte (CT) Lever

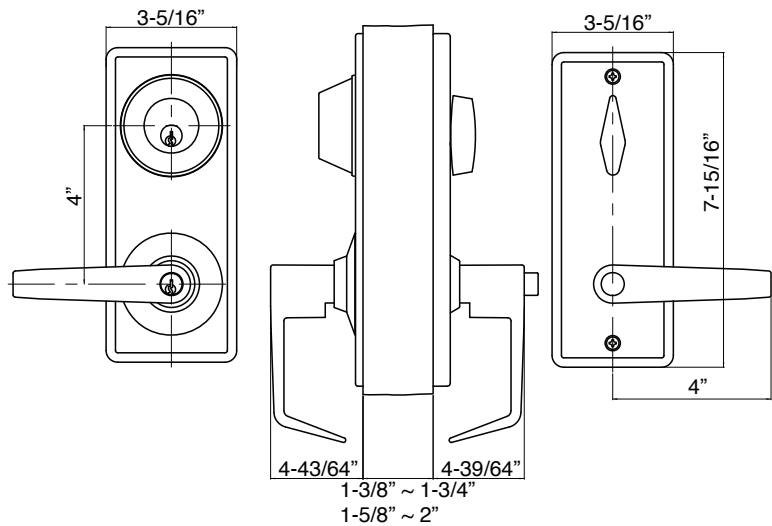

Handlesets & Levers

400 SERIES HANDLESETS



MAYFAIR (MA)
US10B



IMPERIAL (IM)
US15



KELLINGTON (KN)
US12P



500T SERIES LOCKSETS



ROYAL (RY)
US15



MANHATTAN (MH)
US10B



ESCORT (ET)
US3



PALMER (PA)
US26



SHELBY (SY)
US12P



JURAN (JU)
US15A

Sever Design

500T SERIES LOCKSETS



CAMBER (CM)
US15

Knob Design

100T SERIES LOCKSETS



RUBY (RB)
US12P



OLYMPUS (OS)
US10B



BALA (BA)
US32D



GUARDIAN (GN)
US32D

COMBOSET 300T Series



300T
US32D

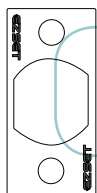

9782-square 9783-round

4-way plate is available for converting drive-in latch to 1" x 2-1/4" square mortise latch.

ANSI Grade 3

Dead Latches for 500TZ Entrance

Optional: 9045 square corner

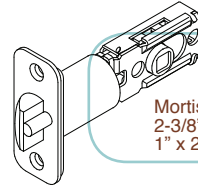

9045R

Mortise Dead Latch
2-3/8" or 2-3/4" adjustable backset
1" x 2-1/4" Round Corner Faceplate

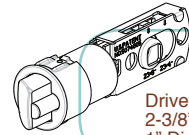

9045C

Drive-in Dead Latch
2-3/8" or 2-3/4" adjustable backset
1" Diameter



D924 Dead latch drive-in cap for converting mortise latch to Drive-in Latch

Spring Latches for 101T, 102T, 501TZ, 502TZ

Optional: 9072 square corner

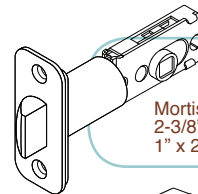

9074

Mortise Spring Latch
2-3/8" or 2-3/4" adjustable backset
1" x 2-1/4" Round Corner Faceplate

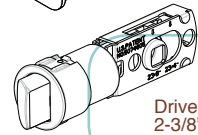

9076

Drive-in Spring Latch
2-3/8" or 2-3/4" adjustable backset
1" Diameter



D907 Spring latch drive-in cap for converting mortise latch to Drive-in Latch

Dead Latches for 100T Entrance

Optional: 9071 square corner

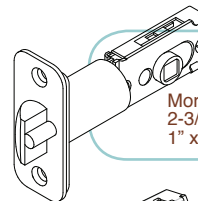

9073

Mortise Dead Latch
2-3/8" or 2-3/4" adjustable backset
1" x 2-1/4" Round Corner Faceplate

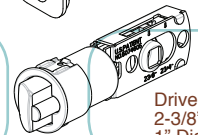

9075

Drive-in Dead Latch
2-3/8" or 2-3/4" adjustable backset
1" Diameter



D904 Dead latch drive-in cap for converting mortise latch to Drive-in Latch



by LIBERTY BUILDING PRODUCTS

Deadbolt

200B SERIES



SINGLE CYLINDER
US3



DOUBLE CYLINDER
US3



ONE SIDED (Full Bore)
US32D



ONE SIDED (Half Bore)
US32D

Latches for 200B

Optional: 9091 square corner
9091UL UL square corner
9092UL UL round corner

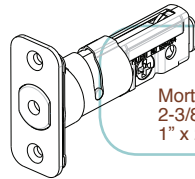

9092
Mortise Deadbolt Latch
2-3/8" or 2-3/4" adjustable backset
1" x 2-1/4" Round Corner Faceplate

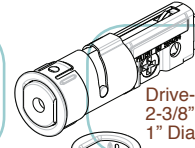

9093
Drive-in Deadbolt Latch
2-3/8" or 2-3/4" adjustable backset
1" Diameter

D909



Deadbolt latch drive-in cap for converting mortise latch to Drive-in Latch

Sliding

DOOR LOCK

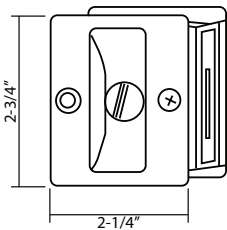

US3
Passage



US15
Privacy

SPECIFICATIONS

Door Prep
Door Fitting
Exposed Trim
Strike

2-1/4" H x 1-3/4" W notch.
1-3/8" ~ 1-3/4" door thick.
Brass, stainless steel, or zinc alloy.
1" x 2-1/4" rectangular.

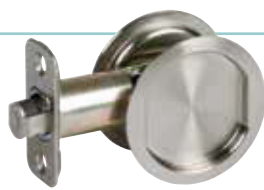

US15
Passage

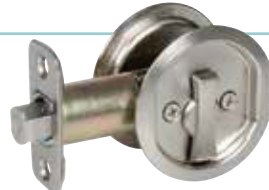

US15
Privacy

Fits 2-1/8" cross bore
2-3/8" fixed
backset latch

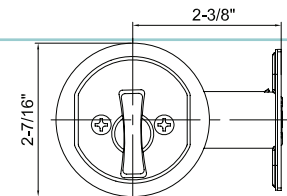

FINISHES



PVD
Lifetime



US3
Polish Brass



US5
Antique Brass



US10B
Oil Rubbed Bronze



US12P
Tuscany Bronze



US15
Satin Nickel



US15A
Pewter



US26
Polish Chrome

Not all styles available in all finishes. See finish chart on page 10 for details.

Finish

AVAILABILITY

SERIES	ITEM	Abbrev	PVD	US3	US5	US10B	US12P	US15	US15A	US26	US26D	US32D
			505	605	609	613		619	620	625	626	630
Interconnected Handleset and Solid Brass Levers												
400 Interconnected	CHATEAU	(CH)	●			●	●	●	●	●		
	FAIRMONT	(FT)	●			●	●	●				
	RICHMOND	(RI)	●			●	●	●	●	●		
Handleset, Interconnected Lock, Levers, Knob, Deadbolt and Combo Pack												
400 2PC Type	IMPERIAL	(IM)	●	●	●	●	●	●	●	●		
	KELLINGTON	(KN)				●	●	●		●		
	MAYFAIR	(MA)		●		●	●	●	●			
500T	CAMBER	(CM)				●	●	●				
	ESCORT	(ET)		●		●				●	●	
	JURAN	(JU)		●		●	●	●	●	●		
	MANHATTAN	(MH)		●		●	●	●	●	●		
	PALMER	(PA)		●		●	●	●	●	●		
	ROYAL	(RY)	●	●	●	●	●	●	●	●		
	SHELBY	(SY)				●	●	●				
300IL 4" CTC				●		●	●					
200B	DEADBOLT		●									
100T	BALA	(BA)		●	●	●	●		●	●	●	●
	GUARDIAN	(GN)		●	●							●
	OLYMPUS	(OS)		●	●	●	●		●	●		●
	RUBY	(RB)		●	●	●	●	●	●	●		●
300T/310T Combo			●	●							●	
Contemporary Handleset Interconnected Lock, Levers and Deadbolt												
400	DEXTON	(DN)					●	●		●		
500AM	AUSTIN	(AT)						●		●		
Contemporary	HOLLYWOOD	(HW)						●		●		
	SOHO	(SH)						●		●		●
301IP 5-1/2" CTC							●		●			
301IS 5-1/2" CTC							●		●			
200TS	DEADBOLT							●		●	●	
200TR	DEADBOLT							●		●	●	

● Product available in stock. Please refer to price book for details. Other finishes may be available upon request. Please allow longer lead time, min. 300 lock order.

Accessories

Lock Strikes



9101
1-1/8" x 2-3/4"
"T" type with tab



9102
1-3/4" x 2-1/4"
Full lip with tab
square corner



9103
1-3/4" x 2-1/4"
Full lip with tab
1/4" radius round corner



9108
1-3/4" full round with
tab for tubular type
drive-in latch



9125
1-1/4" x 2-3/4"
"T" type adjustable

Deadbolt Strikes



9111
1-1/8" x 2-3/4"
Rectangular
square corner



9112
1" x 2-1/4"
Rectangular
square corner



9113
1" x 2-1/4"
Rectangular
1/4" radius
round corner



9117
1-3/4" x 2-1/4"
Full lip
1/4" radius
round corner



9119
1-1/4" x 3-5/8"
Security strike
1/4" radius
round corner



9119F
1-7/8" x 3-5/8"
Full Lip
Security Strike
1/4" radius
round corner

Keys



TE5



HK5

KW1 5-Pins

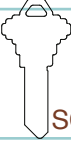

SC5

SC1 5-Pins



HK6



SC6

SC4 6-Pins



9301-K
KW1



9301-S
SC1 & SC4





**LIBERTY
BUILDING
PRODUCTS**

Barn Door Hardware • Builders Hardware • Commercial Hardware
Hinges • Jambs • Locksets • Pocket Door Frames • PVC Products • Transoms

7 Mary Way • Hainesport, NJ 08036
Tel: 1-609-261-2200 • Fax: 1-609-261-2233
liberty@libertybp.net • www.libertybp.net

LibertyC03 02/2023