



# The Birch

Reverse 1 ½ Story Plan

\*\*\*\*\*

Base Price without Lot:

Missouri **\$390,000**

Johnson County **\$400,000**

as of 03/01/16, Prices are subject to change

Sales agents:  
**Sally Moore & Team**  
 Keller Williams  
 Platinum Partners

**816-268-3828**  
 sally@sallysellsmoore.com



- Energy Star 3.0 Certified
- Saves \$Thousands/yr in Utilities
- Approx. 3342 sq. ft.
- 4 bedrooms / 3 ½ Bath
- Open & Functional Floor Plan
- Granite Countertops and Upscale décor & amenities
- Luxurious Main Level Master Suite
- Convenient Home Office
- Lower Level Wet Bar - Great for Entertaining
- Superior materials & craftsmanship such as TG Gold subflooring, screwing off floors, Ext. SW Super Paint, 30-year Roof, etc.
- Ceiling fan in every bedroom
- Covered Deck & Stamped Patio – Wonderful Outdoor Living Spaces
- Abundant Cabinets & Storage

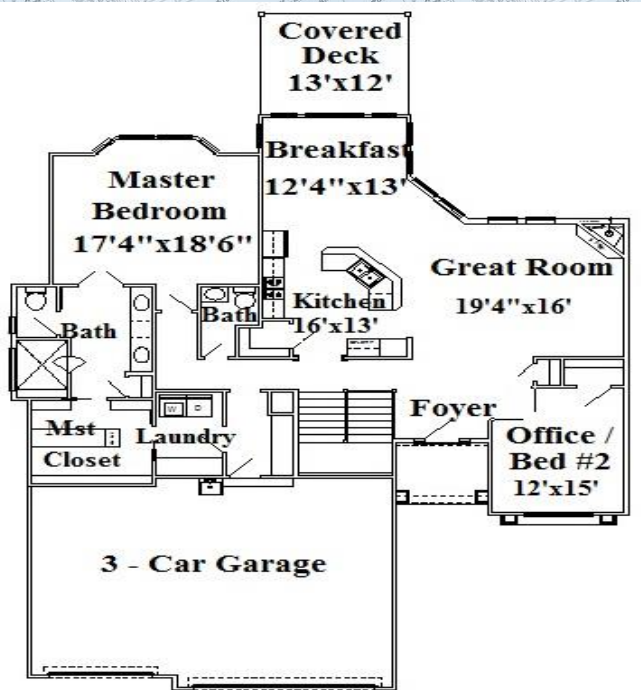

Main Level – approx. 1947 sq. ft.

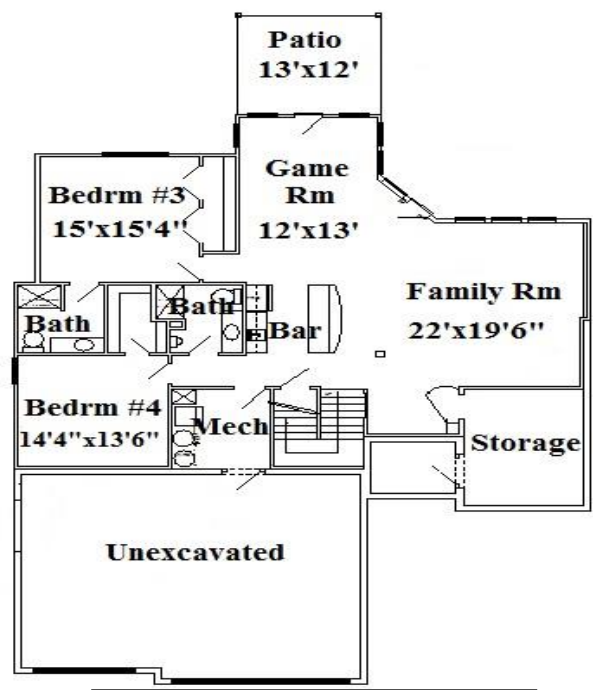

Lower Level – approx. 1395 sq. ft.



**Kevin Stallings of D and D Building, Inc. (dba Dreams & Design Building, a design/build firm)** is the premier *luxury* home builder in the Kansas City metro area!

Along with 25 years of construction experience, he has also garnered several prestigious building awards. Most recently, his homes won the 2014 & 2015 Parade of Homes Grand Prize & First Place Awards!

Kevin's knowledge for energy efficient designs has made him one of a few Midwest builders of Energy Star 3.0 certified homes. Our homeowners have enjoyed average utility savings of over \$2,200 per year!

Kevin is also on the forefront of technology by working with new and innovative construction materials & techniques, including Geo Thermal & Zip system. As a custom builder, Kevin and his staff, including in-house designers, can personally design and build the home of your dreams!

\*\*\*\*\*

**P. O. Box 7014  
Lee's Summit, MO 64064  
816-427-5217  
DandDBuilding@gmail.com**

