



Assembly
Guidelines

Mini-Bike Assembly Guidelines

Warranty Information

Products manufactured by Manufacturer bear the following limited warranty:

Manufacturer warrants that goods delivered will be of the kind and quality described in the retailer's order or contract and will be free of defects in workmanship or material. Should any failure to conform to this warranty appear within thirty (30) days after the initial date of delivery. Manufacturer shall, upon notification and substantiation that the goods have been stored, installed, maintained and operated in accordance with Manufacturer's recommendations and standard industry practice, correct such defect by suitable repair or replacement as its own expense.

This warranty is exclusive and is in lieu of any warranty of merchantability, fitness for a particular purpose or other warranty of quality, whether expressed or implied except of title and against patent infringement. Correction of non-conformities, in the manner and for the period of time provided above, shall constitute fulfillment of all liabilities of the seller to the purchaser with respect to, or arising out of the goods, whether based on contract, negligence, strict tort or otherwise.

Limitation of Liability: Manufacturer shall not under any circumstances be liable for special or consequential damages such as, but not limited to damage, or loss of property or equipment, loss of profits or revenue, loss of capital, cost of purchased or replacement goods, or claims of customers or purchaser for service interruptions. The remedies of the purchaser set forth herein are exclusive, and the liability of manufacturer with respect to any contract, or anything done in connection therewith such as the performance or breach thereof, or from the manufacture, sale, delivery, resale, installation or use of any goods covered by or furnished under this contract whether arising out of contract, negligence, strict tort, or under warranty, or otherwise, shall not, except as expressly provided herein, exceed the price of the goods upon which such liability is based. **This is the only warranty on any of Manufacturer's products. NO other writing or description shall be construed as a warranty.**

Products manufactured by other than Manufacturer bear the following limited warranty: Manufacturer warrants that the goods manufactured by others will conform to the description herein stated. NO other warranty express or implied is made. Any warranty of the manufacturer is hereby assigned and transferred to the buyer. Furthermore, except for the manufacturer's warranty, if any, the products sold hereunder are sold AS IS. Manufacturer is not liable for any incidental or consequential damages in connection with these products.

Mini-Bike Assembly Guidelines

IMPORTANT! READ THIS PAGE BEFORE ANY ASSEMBLY

Mini-Bikes must be operated in accordance with all applicable laws and regulations and riders must comply with all requirements regarding head, eye and body protection. Please check with appropriate government agencies before operating your mini-bike. Prior to any operation, all riders must be properly trained in, and fully knowledgeable of all mini-bike functions and safe operation and procedure. Full compliance with all information set forth in these guidelines is mandatory. **FAILURE TO FULLY COMPLY IS UNSAFE AND COULD POSSIBLY RESULT IN SERIOUS INJURY OR DEATH.**

Chain Guard

WARNING: This kit does NOT contain a Chain Guard. IT IS UNSAFE TO OPERATE A MINI-BIKE WITHOUT A CHAIN GUARD. DO NOT OPERATE WITHOUT A CHAIN GUARD COVERING BOTH SPROCKETS AND THE CHAIN. Ask your engine provider to provide with an appropriate Chain Guard.

Assembly Safety

Assembly should be performed by knowledgeable individuals using appropriate tools. Please consult with your retailer or a Kart or Mini-Bike shop or your local, knowledgeable mechanic if you experience problems with, or have questions about any portion of the assembly process, individual or overall function or operation whatsoever.

CAUTION! COMPRESSED AIR CAN BE DANGEROUS! Containment guards and eye protection should be used when inflating tires. Assemble tires and wheels with care. Never force a tire onto a wheel by prying against the wheel rim. A properly assembled tire will seat itself onto the wheel rim with less than 15 pounds per square inch (psi) of air pressure.

Mini-Bike Assembly Guidelines

ASSEMBLY GUIDELINES

About the Kit Contents

All of the components you need to assemble a mini-bike chassis have been delivered to you in one cardboard carton. **Wheels, tires, seat, engine mounting hardware, clutch and chain guard are not included and must be obtained and installed before you operate your mini-bike.**

Folded into this booklet, is a single sheet entitled “Mini-Bike Components Checklist”.

Unpack & Organize Parts

As you unpack, identify the part and hardware that have been included in your kit.

22 Frame Kit Parts List

- (1) Main Frame
- (1) Upper Fork
- (2) Fork Springs
- (2) Fork Lowers
- (1) Scrub Brake Pedal
- (1) Brake Spring
- (1) ½” ID Brake Pedal Washer
- (1) Cotter Pin for Brake Pedal
- (1) ½” x 5” Fork Bolt and Nylock Nut

Frijole and Monster Frijole Frame Parts List

- (1) Main Frame
- (1) Upper Fork
- (1) ½” x 5” Fork Bolt and Nut
- (2) Jack Shaft Mounts (Monster Version Only)
- (4) Nuts and Bolts to attach Jack Shaft Mounts (Monster Version Only)
- (1) Scrub Brake Pedal (Original Frijole Model Only)
- (1) ½” ID Brake Pedal Washer
- (1) Cotter Pin for the Brake Pedal

Now, on to the fun stuff...

Mini-Bike Assembly Guidelines

1. Paint Fork & Frame

- Thoroughly clean the Fork and Frame, making sure to remove the rust proofing oil.
- The 1/2 - 18 x 5" Bolt connects the Fork to the Frame. Paint its head of the bolt, but the threaded portion should be left unpainted.
IMPORTANT: DO NOT OVER-PAINT. Too much paint or spill may result in parts not fitting properly.
- Allow the paint to dry thoroughly before any assembly.

2. Attach Fork to Frame

- Attach the Fork to the Frame using the 5/8-18 x 6" Bolt and the 5/8-18 Locknut which for packing purposes only is installed onto the 5/8-18 x 6" Bolt.
- Tighten the Locknut until snug, and then back it off slightly to allow the Fork to move freely back and forth.
- Attach the Lower Fork Legs to the Fork Spring by winding the two together. They can only be wound in one direction. Insert the Lower Fork Leg into the guide in the bottom of the forks.
- Wind the Fork Spring onto the Coil attached at the bottom of the forks. It can only be wound in one direction. Wind the spring until it has gone all the way around and is at the top of the coil.
- Repeat this process on the remaining side. Align both of the Lower Forks Legs so your axel can go through both sides.

3. Installing the Scrub Brake

- Insert the portion of the brake pedal that is used by the foot to push down on. It is approximately 3" in length. Insert this part of the brake pedal into the front tab on the left side of your frame. This step will require twisting and turning the entire brake pedal to complete its installation.
- You will then need to insert the right side of the brake pedal into the front tab located on the right side of the frame.
- Once you have inserted the right side of the brake pedal, flip the brake pedal around until it is stopped by and resting underneath the footpeg located on the left side of your frame.
- Locate and install the 1/2" ID washer onto the right side of the brake pedal. Once installed insert the Cotter Pin into the hole closest to the end.

Mini-Bike Assembly Guidelines

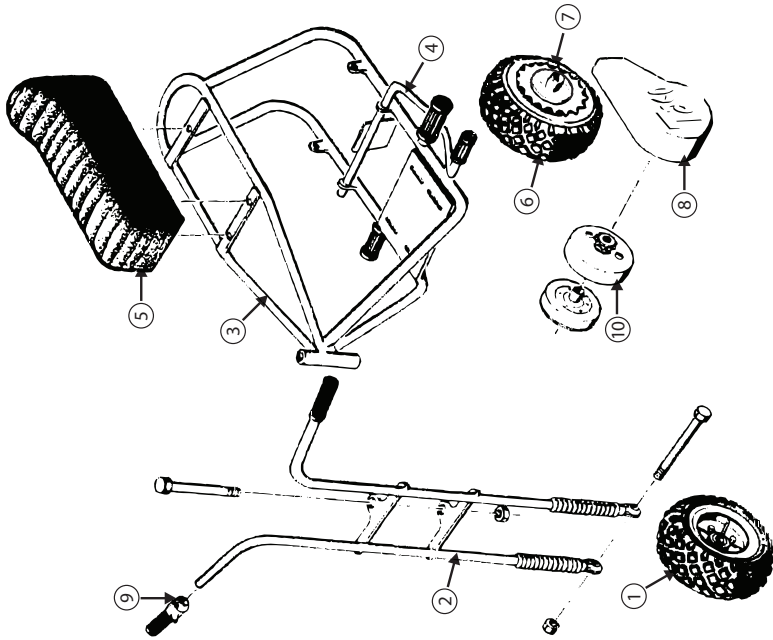

BASIC MINI-BIKE ASSEMBLY ILLUSTRATED

Mini-Bike Assembly Guidelines

Part Number	Description	Quantity	Req.	Part Number	Description	Quantity	Req.
1)				4)			
T-20	FRONT WHEEL ASSY	1		T-32	BRAKE LEVER	1	
T-20TI	410/3.50X5 TIRE	1		T-32-1	RETURN SPRING	1	
T-20TU	410/3.50X5 TUBE	1		5)			
T-20-1	WHEEL ONLY W/ BEARINGS	1		T-22-2	SEAT	1	
T-20-4	BEARING	2		6)			
T-20-5	BOLT & NUT	3		T-31	REAR WHEEL ASSY	1	
T-20-7	5/8 FRONT AXLE & NUT	1		7)			
T-20-8	FRONT AXLE SPACERS	2		T-31-1	60T SPROCKET	1	
2)				T-31-2	REAR AXLE & NUT	1	
FORK ASSY COMPLETE		1		T-31-3	REAR WHEEL SPACERS	2	
T-21-1	FRONT FORK UPPER	1		8)			
T-21-2	LOWER FORK LEG	2		T-32	TACO CLUTCH COVER	1	
T-21-3	FORK SPRING	2		9)			
T-21-4	NUT & BOLT STEERING	1		T-33	THROTTLE ASSY	1	
3)				10)			
MAIN FRAME TACO 22		1		T-34	CLUTCH ASSY	1	
T-30-1	FOOTREST RUBBERS	3					
					COMPLETE ROLLING CHASSIS	1	
					/ LESS CLUTCH		
					/ LESS PAINT	1	

Mini-Bike Assembly Guidelines

— Notes —