

# B1515R Pan & Batten System

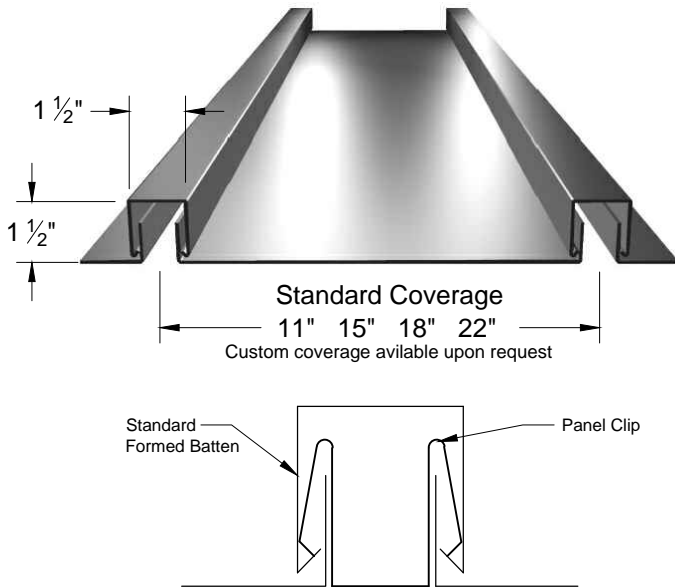

**Applications**

Architectural roofing on slopes 3" or greater. Continuous lengths up to 45 ft. Vertical walls, conical tapers and radius barrels.

**Substrates**

Solid deck / Plywood or Rigid insulation over decking.  
 Requires minimum 30# felt underlayment.  
 Requires rosin slip sheet for roof application.

**Materials**

Aluminum (3000 series alloy)  
 Galvanized coated steel (G-90)  
 Alum-Zinc coated steel (AZ-50 & AZ-55)  
 Copper & lead coated Copper  
 Also available in Zinc, Pre-Weathered Zinc & Stainless Steel

**Standard Gauges**

.032" .040"  
 24 ga. 22 ga.  
 24 ga. 22 ga.  
 16 oz. 20 oz.

**Finishes**

Kynar & Metallic Fluoropolymer Coatings  
 Mill Finish, Brushed, Anodized  
 Smooth or Stucco Embossed

**Manufacturing**

Factory Formed

**Panel Side Joint**

Traditional wide snap on batten. Battens can be standard roll formed or custom aluminum shapes.

Some panels configurations are not suitable for all applications.  
 Contact sales & engineering for more information.

## Components

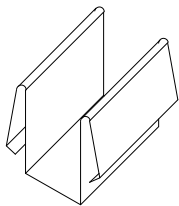

**Standard Batten Clip**  
 One piece 24 gauge galvanized steel clip. Allows for free movement of panels during thermal expansion and contraction. Also available in Stainless Steel.

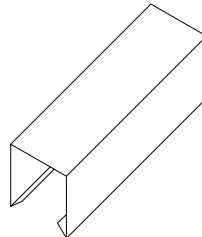

**Formed Batten**  
 Standard batten roll formed to match the pan. 1 1/2" x 1 1/2"

**Aluminum Batten**

Special extruded aluminum shapes can be custom designed.

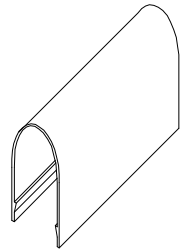

**Bearing Plate**

6" x 6" 22 ga. galvanized. For clip support over rigid insulation.

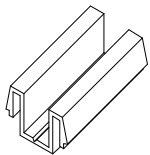
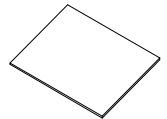

**Special Low Base Aluminum Clip**  
 Continuous low base channel. Extruded lengths up to 22'.

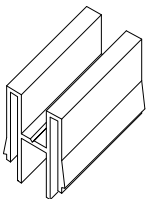

**Special High Base Aluminum Clip**  
 Continuous high base channel. Extruded lengths up to 22'.

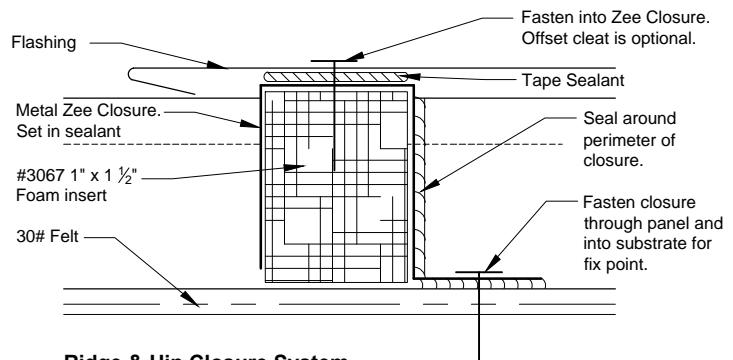

**Ridge & Hip Closure System**

100' closed cell foam and 10' metal Zee closure. Cut foam & metal closure to suit between battens.

Updated December 2011

Merchant & Evans, Inc.  
 308 Connecticut Drive  
 Burlington, NJ 08016

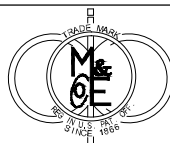

Phone: 800-257-6215  
 Phone: 609-387-3033  
 Fax: 609-387-4838  
 www.ziprib.com